



Rubber Roof Kit Fixing Guide

Please note: Either side of the membrane can be laid and used as the upper surface. Open the box to check contents and familiarise yourself with the components.



1 Remove the old roof covering and any nails. Replace the roof boarding if the roof is damaged or if the roofing felt does not come off.



2 Relax the rubber membrane by laying it in position on the roof for at least 20 minutes.



3 Apply the adhesive working from the centre of the roof outwards in stages. **DO NOT** let the adhesive dry out.

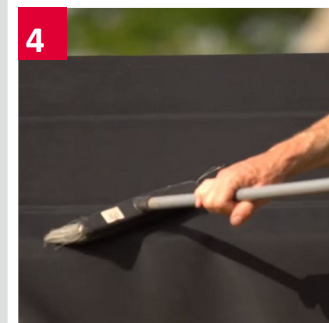

4 Put membrane on and sweep down to ensure all trapped air bubbles are removed and membrane bonds to the adhesive.

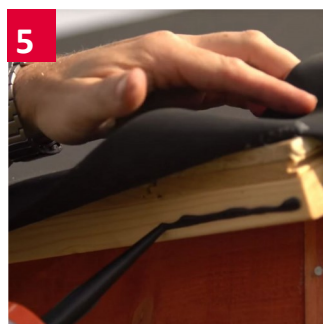

5 Apply edge sealant using a mastic gun to the roof edges. Once dried this will hold the membrane securely.

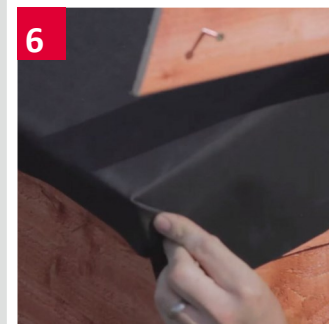

6 Replace any existing timber barge boards to help secure the membrane perimeter.

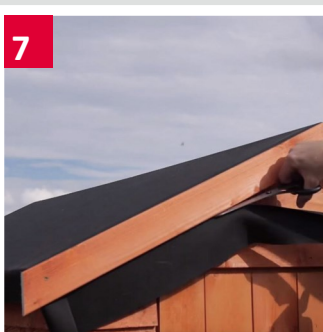

7 Trim the Rubber membrane back using scissors.

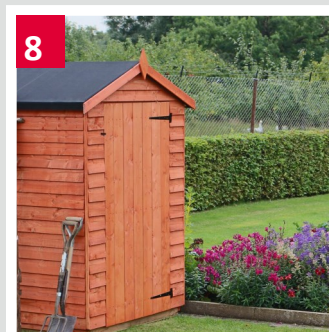

8 You have successfully installed your Rubber Roof Kit.



Onduline Building Products Ltd, Eardley House, 182-184 Campden Hill Road, London, W8 7AS

Tel: 0207 727 0533 Fax: 0207 792 1390

Email: enquiries@onduline.net

www.onduline.co.uk